

INSTALLATION INSTRUCTIONS – OAK TONGUE & GROOVE (T&G) RANGES

DIRECT FIX & FLOATING METHODS FOR - DE MARQUE, PRESTIGE & PRONTO OAK WIDE PLANK

For our Oak Tongue & Groove ranges we provide essential guidelines that must be followed to ensure a quality install. Please read the entire document as a range of important considerations are noted for both **Direct Fix & Floating installations**.

We encourage you to use professional contractors to ensure the flooring is correctly installed. All direct fix slab installations require an appropriate Moisture Barrier (MB) system. A system approach with a compatible MB and elastomeric adhesive (**same brand for both items**) is required to support warranty provisions. **For all types of installation substrate flatness is critical; sub-floor should not exceed 3mm over a 3m radius in all directions. Any hollows or humps need to be assessed and rectified prior to installation.** Please follow manufacturer's guidelines for leveling compound application and drying times.

We do not recommend our T&G Oak ranges to be direct fixed to a joist and bearer system. The 21mm product can be installed on an approved batten system if necessary; acoustic performance may be affected with this method. Batten spacing maximum 300 to 400mm. Mid span end joins require sub-batten. All short end joins require H-pattern, cross linked PVA on short and long edges to secure joins. **Do not use Aquadhere of any type, it is not suitable for structural joint adhesion.** 12-15 mm Oak ranges are not suitable for fixing directly to battens.

Oak T&G planks can be installed for vertical wall features. There are various methods of fixing applicable to this type of application. Please consult with your contractor to assess the optimum approach as each application will vary from site to site. A combination of secret nailing to wood battens along with an elastomeric adhesive will provide a suitable fixing in certain situations.

Please note: Our structural warranty covers the professional installation for use over, In-slab Hydronic under-floor heating only. The warranty will cover both methods of installation (Direct Fix & Floating) provided the heating system is operated and installed in compliance with the strict guidelines of the heating manufacturer's recommendations. The system should not be operated with heat settings in excess of 27 degrees Celsius. No other type of heating system other than Hydronic in-slab systems will be covered by our structural warranty. In-Screed hydronic heating or electric heat blanket systems are not covered by our warranty.

Before proceeding with installation site conditions need to be inspected by the installer prior to commencing. Site specific circumstances such proximity to water, river systems and coastal regions along with other climatic extremes will require more complex installations methods and maintenance. Under floor inspections must be conducted before installation whenever possible. **Ensure installers are wearing appropriate personal protective equipment and the site is well ventilated and protected from excessive heat, direct sunlight, or moisture ingress. Use temporary window coverings if nothing exists.**

PRE-INSTALLATION REQUIREMENTS ALL METHODS

Importantly, a professional contractor should perform the installation. The installation process and method selected is solely the responsibility of the contractor and you must be satisfied that the contractor is qualified to conduct your site installation. Should you have any concerns either contact your retailer or visit the helpful site at <https://www.atfa.com.au/>

1. **At site, please store the product in original cartons placed on a flat, dry area away from any extreme temperatures or moisture.**
2. **The planks must be carefully inspected prior to install to detect any imperfections, do not install planks that contain defects. FAULTY PLANKS SHOULD NOT BE INSTALLED.** If certain planks are displaying slight bow or twist set aside under load to assist with site acclimatisation, these planks can be recycled into the install later. If further assembly issues arise, please contact point of purchase immediately. **A waste factor of 8-10 % is required for length cutting, sorting and visual selection.**
3. **The site area must be clean and free of any contaminants, dust, or other construction / painting activity whilst the installation is in progress. Make sure you have the necessary floor covering protection material available if further construction is occurring after the floor installation. Do not use adhesive tape directly on the surface of the planks.**

www.preferencefloors.com.au

Adelaide (SA)

t +61 8 8262 2774
sa@preferencefloors.com.au

Brisbane (QLD)

t +61 7 3875 1688
qld@preferencefloors.com.au

Melbourne (VIC)

t +61 3 9794 5111
vic@preferencefloors.com.au

Perth (WA)

t +61 8 9471 7785
wa@preferencefloors.com.au

Sydney (NSW)

t +61 2 9738 1188
sales@preferencefloors.com.au

FLOATING INSTALLATION – Acoustic underlay with attached moisture barrier (PE) film or an acoustic underlay with 200uM builders’ plastic (BP) is required. PVA adhesive must be DIN Certified D3/BS EN204 for structural joints.

Use Sika, Mapei, Roberts or similar professional flooring cross-linked adhesives that comply with the D3/BS EN204 formula. Generic PVA’s such as Aquadhere any type cannot be used under any circumstances; they are not suitable for gluing structural joints. If the floating option is selected the install performance and workmanship is a matter between buyer and reseller/ installer. Floating installations require a moisture barrier and acoustic membrane on top of all substrates. **Concrete slab must be dry, approx. 2.5% and wood-based floors dry, maximum 14 %.** Expansion provisions must be followed to ensure warranty guidelines are compliant.

1. Place acoustic underlay with PE film & or 200uM BP with underlay on sub-floor & up wall skirt area (>50mm), overlap and tape.
2. Once the planks are selected apply cross linked PVA Adhesive which meets the D3/BS EN 204 specifications to the top of the Tongue profile on both long and short ends. Apply adhesive to the underside of the groove. **Do not use excessive adhesive as it may squeeze onto the plank surface. Only apply adhesive to a small number of planks at a time to avoid curing prior to install.**
3. Floor expansion and contraction requires **perimeter expansion of 12 – 15mm for floating installations, this cannot be avoided. Width areas greater than > 6m and length runs greater than >11m** will require installation of expansion and transmission joints to assist the natural movement of a floating installation. **As a guideline allow an extra 1- 2 mm expansion gap for every extra 1m of width over the standard raft size, (6m x 8m).** Adequate space around heating and service ducts should be created to allow the floor to expand and contract. **Refer Figure 2 & 3. Note: caulking will hinder floating floor movement, it should not be used.**
4. If the client objects to trim inclusions, please keep a record that the client did not wish to include expansion trims. Perimeter expansion guidelines must be followed. Wherever possible, each room should be treated as a separate install, this will assist in reducing floor movement and floor tension for an optimum install.
5. **Large objects such as Kitchen Island benches should not be placed on a floating floor.** The floor planks need to be installed around the perimeter of the Island Bench or under the bench kick boards/fascia to allow for natural floor movement.
6. **First and last plank length should not be less than 300 mm, short end joins on parallel planks should be at least 300 mm in distance from the adjoining plank, Figure 1.** Plan the layout of plank lengths and for visual aspects prior to final fix. This will assist in providing a balanced blend of grade, colour, and joint alignment. For optimum visual impact planks should run in the direction of the longest wall area. Regularly review install alignment.
7. The installer needs to establish a method for pulling the planks tightly together to ensure gapping or bowing does not eventuate during the install process. Methods such as cramping, wedging or ratchet mechanisms are commonly used. The installed plank areas must be weighted to assist in keeping the floor flat & stable. Avoid foot traffic whilst adhesive is curing, refer adhesive instructions.
8. **Cover flooring with adequate protection if construction or painting is still occurring at the site.** The finished floor must be protected from intense direct sunlight. Screens or Blinds must be used to inhibit direct sun. Items such as rugs and mats should not be introduced until the floor has been able to acclimatise in its environment, this will take approx. 8 weeks.

Figure 1.

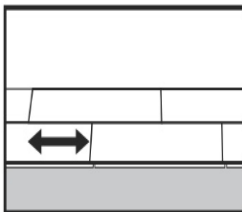

Figure 2.

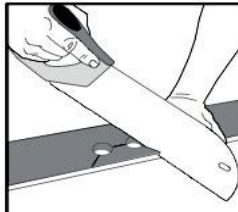
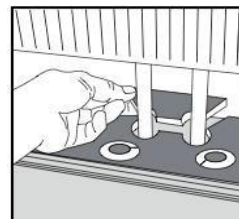

Figure 3.



**DIRECT ADHESIVE FIX INSTALLATION FULL TROWEL SPREAD
THIS IS THE OPTIMUM METHOD OF INSTALLATION FOR T&G ENGINEERED PLANKS**

Note: 12mm thickness is not recommended for direct fix over a concrete slab.

1. Substrate materials such as structural Plywood and P/Board should be flat, dry (<14%) free of moisture ingress and secure. **Concrete Slab must be dry approx. 2.5%** prior to installation. **Substrate flatness is critical; sub-floor should not exceed 3mm over a 3m radius in all directions.** For concrete slabs, any hollows or humps must be levelled prior to installation. Please follow manufacturer's guidelines for leveling compound application and drying times. **Do not install if levelling compound is not dry.**
2. All wood based sub-floor edges and surfaces must be lightly sanded to ensure flatness, particularly at the joins. Surface area must be sanded to remove any foreign substances such as waxes or paint. This will aid the adhesion process.
3. Inspect all planks carefully prior to install to detect any imperfections. **FAULTY PLANKS SHOULD NOT BE INSTALLED** and will not be covered by warranty provisions. If certain planks are displaying slight bow or twist set aside under load to assist with site acclimatisation, these planks can be recycled into the install later. If further assembly issues arise, please contact point of purchase immediately, **do not install defective planks. If in doubt stop and follow up immediately to resolve the issue.**
4. Whenever possible cover windows & door openings 24 hours prior to install to moderate the interior temperature, reduce excessive heat, and direct UV. Do not install in during temperature extremes, always follow adhesive manufacturers guidelines.
5. **An optimum install requires full trowel adhesive using a minimum 4mm square notched trowel. A recognised wood flooring adhesive & moisture barrier (use same brand for both items) such as Sika, Mapei or similar system is required. Refer, Pictures 1 & 2.** The planks must be weighted to assist with high bond outcomes. Avoid foot traffic during the adhesive curing time. **Note: Bead Gluing is not considered full contact bonding and is not covered by our warranty. For concrete slab installs, 3 in 1 adhesive with 'claimed' moisture barrier attributes must be applied with a compatible moisture barrier to comply with our warranty. No warranty applies without proof of an additional moisture barrier for the concrete slab. Keep photographic files to support your workmanship methods and slab testing data.**
6. To optimise structural and visual performance, first and last plank **length should not be less than 300 mm and short end joins on parallel planks should be at least 300 mm lengthways in distance from the adjoining plank. Refer, Figure1.**
7. Carefully plan the layout of plank lengths and visual aspects / knots prior to final fix. This will assist in providing a balanced blend of grade, colour, and joint alignment. It is always a smart idea to make sure the owner's expectations are consistent with the installer's layout plan. Heavily featured planks can always be used under cabinetry or similar less obvious locations.
8. For optimum visual impact planks should run lengthways in the direction of the longest wall area, including hallways.
9. **Large objects such as Kitchen Island benches can be installed onto a Direct Fixed floor or installed later. Please make sure the installed floor is well protected if other trades are still to complete their fit outs.**
10. On Plywood and P/Board, secret nailing at 200-300mm intervals can assist with alignment issues and adhesion in difficult areas.
11. Perimeter expansion varies from site to site. The installer needs to assess perimeter expansion opportunities to maximize the natural movement of the floor for expansion and contraction especially, hallways >11m, door thresholds, service ducts and heating pipes. In certain circumstances compartmentalising room sizes or length runs is necessary to avoid floor performance and appearance issues. If required for aesthetic purposes, a flexible caulking compound to a maximum of 5mm is suitable with direct fix adhesive installations. Remember, caulking significantly hinders expansion & contraction.

www.preferencefloors.com.au

Adelaide (SA)

t +61 8 8262 2774
sa@preferencefloors.com.au

Brisbane (QLD)

t +61 7 3875 1688
qld@preferencefloors.com.au

Melbourne (VIC)

t +61 3 9794 5111
vic@preferencefloors.com.au

Perth (WA)

t +61 8 9471 7785
wa@preferencefloors.com.au

Sydney (NSW)

t +61 2 9738 1188
sales@preferencefloors.com.au

DIRECT ADHESIVE FIX INSTALLATION CONTINUED

12. **Please cover flooring with adequate protection if construction or painting is still occurring at the site.** Floor protection such as compressed cardboard, thin MDF panels or similar are worthwhile but cannot be left in place for an extended period. **Do not use adhesive tape directly on the surface of the pre-finished planks, the coating surface may get damaged when removed.** Incidental scratching, chipping and indentations from external sources are site related and therefore will not be covered by our warranty.
13. Window and door openings must be covered by screens, blinds, or tinting treatments to inhibit direct UV heat and light. **Avoid placing rugs and mats until the floor surface has acclimatised in its environment; allow 8 weeks.**
14. **Do not use a steam mop or wet mopping to clean the floor.** Static or absorbent towelling mops should be used for all natural floor surfaces. When incidental spills occur simply wipe dry with absorbent cloth and use a light bristle broom for daily cleaning. **Refer Picture 3. Do not use generic supermarket floor cleaning solutions on the floor,** we recommend professional floor care products such as **Bona or Loba. Spray Mop Kits and refill floor cleaning** products are readily available online or through popular retail outlets throughout Australia & New Zealand.
15. A Floor Care guide is available for easy download from our website.

Picture 1. Full Trowel



Picture 2. Plank Bonding



Picture 3. Clean Spills



Oak flooring is a natural material that will expand and contract in shape if moisture or humidity is elevated. It may also shrink if moisture or humidity becomes extremely low. As a natural product damage from these circumstances may lead to irreversible damage if the interior temperature and humidity is constantly exposed to extremes. Please review the floor care guide to familiarise yourself with the requirements on how best to live and maintain your timber floor. By following our simple floor care and install guidelines a well-maintained timber floor can last a lifetime. Follow the steps and enjoy a lifetime of nature at its finest.

Disclaimer: Preference Floors has used its reasonable endeavours to ensure the accuracy and reliability of the information contained herein and, to the extent permitted by law, will not be liable for any inaccuracies, omissions, or errors in this information nor for any actions taken in reliance on this information. Products must be installed in accordance with relevant installation recommendations and industry best practices.
© Homemirus Pty Ltd trading as Preference Floors. Head Office 02 97381188